



**SAVEL**

Mobil Container User's Guide

## Transfer Set



### 1.1.PPP Rotary Vane Pumps



PPP series fuel pumps are pumps with positive displacement and self priming with pallet. They are used safely for transfer of low viscosity fluids having explosion risk. Maximum



pressure of rotary vane pumps are **8 bars**. 80 meters pump head could be obtained when coupled with proper motor power. Pump housing has been designed with internal by-pass. Maintenance is easy.

### > Application Areas

They are used in all areas where fuel transfer is made such as ex-proof systems, fuel tank trucks and marine tankers, fuel stations, liquid fuel filling facilities.

### > Fluids

Gasoline, diesel oil, solvents, LPG, kerosene, alcohols, low viscosity minerals and hydraulic oils.

### > Technical Specifications

Ürün Kodu Product Code	Açıklaması Description	Ölçü Dimension	Debi Flow Rate		Basınç Pressure		Motor Engine					Ağırlık Weight	Paket Ölçü Package Dimension	By-Pass
			İnç Inch	Lt/dk Lpm	Gal/dk Gpm	Bar	Psi	Voltaj Voltage	Frekans Hz Frequency	Hız dev/dak Rpm	Hp			
PPP 212	Paletli Pompa Rotary (Sliding) Vane Pump	2 1/2"	750	198	8	116	380	50	800	7,5	5,5	44	34x42x32	Standart Standard
PPP 300	Paletli Pompa Rotary (Sliding) Vane Pump	3"	1250	330	8	116	380	50	800	10	7,5	63	40x56x46	Standart Standard
PPP 212MS	Paletli Pompa (Mekanik Salmastralı) Rotary (Sliding) Vane Pump (Mechanical Seal)	2 1/2"	750	198	8	116	380	50	800	7,5	5,5	50	34x42x32	Standart Standard
PPP 300MS	Paletli Pompa (Mekanik Salmastralı) Rotary (Sliding) Vane Pump (Mechanical Seal)	3"	1250	330	8	116	380	50	800	10	7,5	68	40x56x46	Standart Standard

## 2.1. Three-phase induction motor - Squirrel cage rotor



Explosion Proof Motors (Exd / Exde) - Standard Efficiency - IE1

Product line : Explosion Proof Motors (Exd / Exde) - Standard Efficiency - IE1



Frame	: 112M
Output	: 4 kW
Frequency	: 50 Hz
Poles	: 4Full
load speed	: 1420
Slip	: 5.33 %
Voltage	: 380/660 V
Rated current	: 8.41/4.84 A
Locked rotor current	: 58.0/33.4 A
Locked rotor current (I/In)	: 6.9
No-load current	: 3.60/2.07 A
Full load torque	: 26.9 Nm
Locked rotor torque	: 230 %
Breakdown torque	: 260 %
Design	: N
Insulation class	:
	FTemper
ature rise	: 80 K
Locked rotor time	: 10 s (hot)
Service factor	: 1.00
Duty cycle	: S1
Ambient temperature	: -20°C - +40°C
Altitude	: 1000 Degree of
Protection	: IP55 Approximate
weight	: 62 kg
Moment of inertia	: 0.01607 kgm <sup>2</sup>
Noise level	: 56 dB(A)

	D.E.	N.D.E.	Load	Power factor	Efficiency(%)
Bearings	6307 ZZ	6206 ZZ	100%	0.86	83.1
Regreasing interval	—	—	75%	0.81	83.0
Grease amount	—	—	50%	0.72	82.5

Efficiencies according to the indirect method of IEC 60034-2-1:2007 with stray load losses determined from measurement.

**PERFORMANCE CURVES RELATED TO RATED OUTPUT**  
**Three-phase induction motor - Squirrel cage rotor**

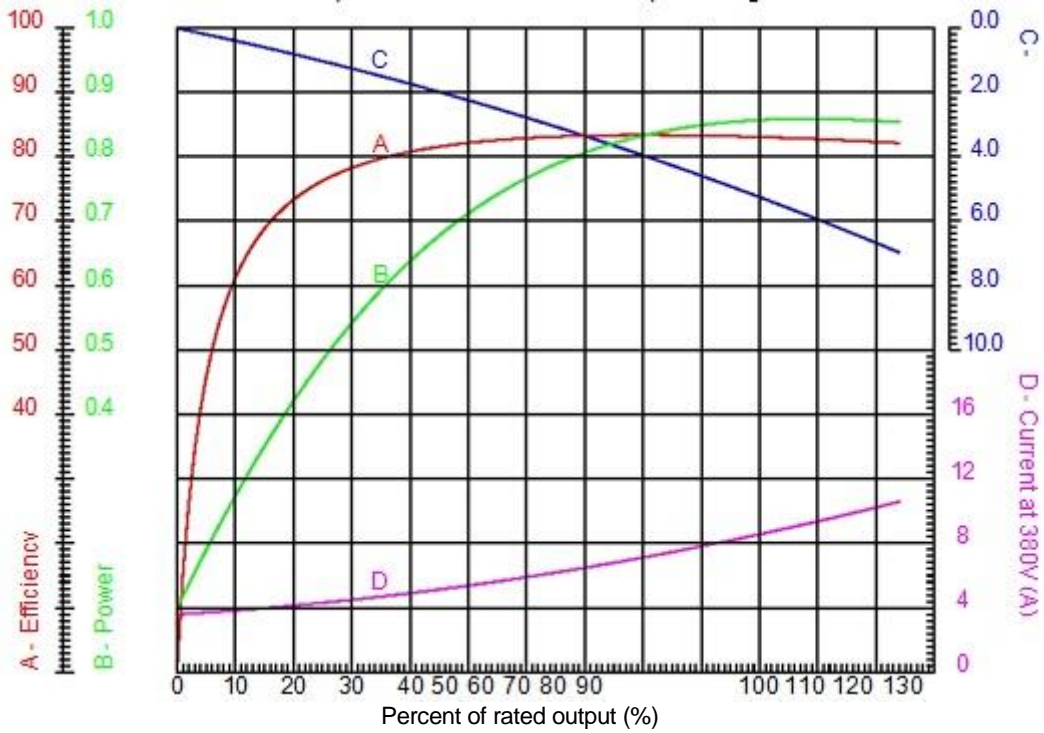

Product line	: Explosion Proof Motors (Exd / Exde) - Standard Efficiency - IE1		
Frame	: 112M	Locked rotor current (I <sub>l</sub> /I <sub>n</sub> )	: 6.9
Output	: 4 kW	Duty cycle	: S1
Frequency	: 50 Hz	Service factor	: 1.00
Full load speed	: 1420	Design	: N
Voltage	: 380/660 V	Locked rotor torque	: 230 %
Rated current	: 8.41/4.84 A	Breakdown torque	: 260 %
Insulation class	: F		

**CHARACTERISTIC CURVES RELATED TO SPEED**  
 Three-phase induction motor - Squirrel cage rotor

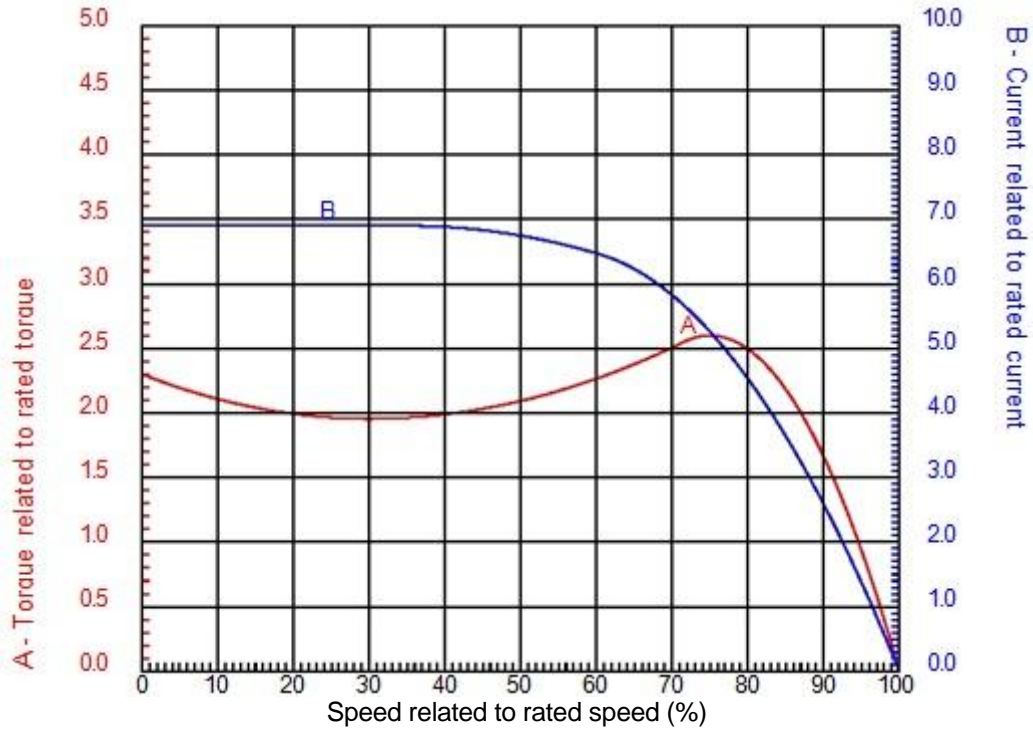

Product line : Explosion Proof Motors (Exd / Exde) - Standard Efficiency - IE1

Frame	: 112M	Locked rotor current (I <sub>l</sub> /I <sub>n</sub> )	: 6.9
Output	: 4 kW	Duty cycle	: S1
Frequency	: 50 Hz	Service factor	: 1.00
Full load speed	: 1420	Design	: N
Voltage	: 380/660 V	Locked rotor torque	: 230 %
Rated current	: 8.41/4.84 A	Breakdown torque	: 260 %
Insulation class	: F		

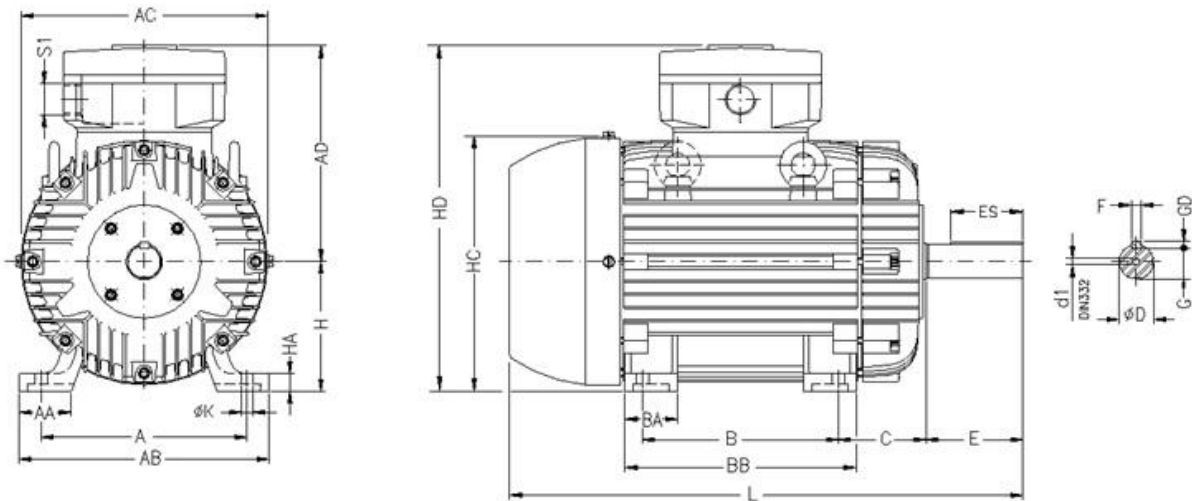

Explosion Proof Motors (Exd / Exde) - Standard Efficiency - IE1  
 Three-phase induction motor 05-NOV-2012  
 Frame 112M - IP55

A	AA	AB	AC	AD
190	48	220	223	243
B	BA	BB	C	CA
140	50	183	70	128
D	E	ES	F	G
286	60	45	8	24
GD	DA	EA	TS	FA
7	24	50	36	8
GB	GF	H	HA	HC
20	7	112	17	237
HD	K	L	LC	S1
355	12	394	448	M32X1,5
d1	d2			
DM10	DM8			

## A. FILLING WITH TRANSFER PUMP



- 1- All the filling valves must be closed.
- 2- Connect the hose of tank truck to the entrance of transfer pump.
- 3- Open the filling valve which of tank to be filled.
- 4- Switch on the transfer pump from the transfer unit's panel.
- 5- Follow the filling on the tank level gauge from the operator room.
- 6- Tank filling must stop until 90%.



7- Firstly, switch off the transfer pump's electricity and then all the filling valves must be closed after the tank filling.

8- Remove the tank truck's hose and then put the counter camlock's cover.

### **B. MANUEL FILING**



1- Connect the tank truck's hose to manual filling valve.

2- Open the filling valve which of tank to be filled.

3- Open the manuel filling valve.

4- Start the filling.

5- Follow the filling on the tank level gauge from the operator room.

6- Tank filling must stop until 90%.

7- All the filling valves must be closed.

8- Remove the tank truck's hose and then put the manuel camlock's cover.

**Note: must be sure that the filling valves closed before and afterwards filling.**